



# ZL400

## Wireless Hotel Door Lock



### Features

- ZigBee communication with simple gateway configuration (RG4100+).
- Work with professional all-in-one ZKBioSecurity software.
- Support real-time remote control.
- With advanced 13.56 MHz Mifare card technology.
- With warning beeps in low battery voltage.
- American standard mortise with 5 latches.
- Customizable password & card sector for issued cards

### Specifications

Material	Zinc Alloy
Software	ZKBioSecurity 3.1.5.0 customized version
Door Thickness	35 - 55 mm
Card Type	ISO14443 (RFID) Type-A S50 1KB / S70 4KB
Battery	4 LR6 AA 1.5V
Co-related Gateway	RG4100+

### Configuration

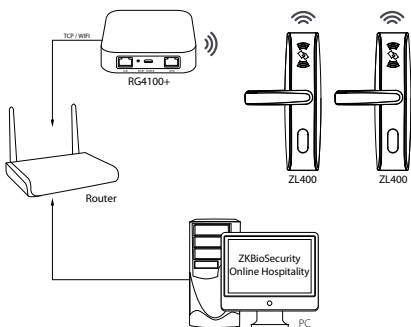

### Dimensions (mm)

